





JASLICE - Stepinčeva 3. Split

Neto površina 91,00 m²

Površina okoliša 218,00 m²

NOVI PREGRADNI ZIDOVI

	zid od "YTONGA" 20 cm, visine do stropa
	zid od "KNAUFA" 10 cm, visine do stropa
	zid od "KNAUFA" 10 cm, visine 150 cm
	zid od "KNAUFA" 10 cm, visine 150 cm, s ostakljenom ALU stijnom do stropa

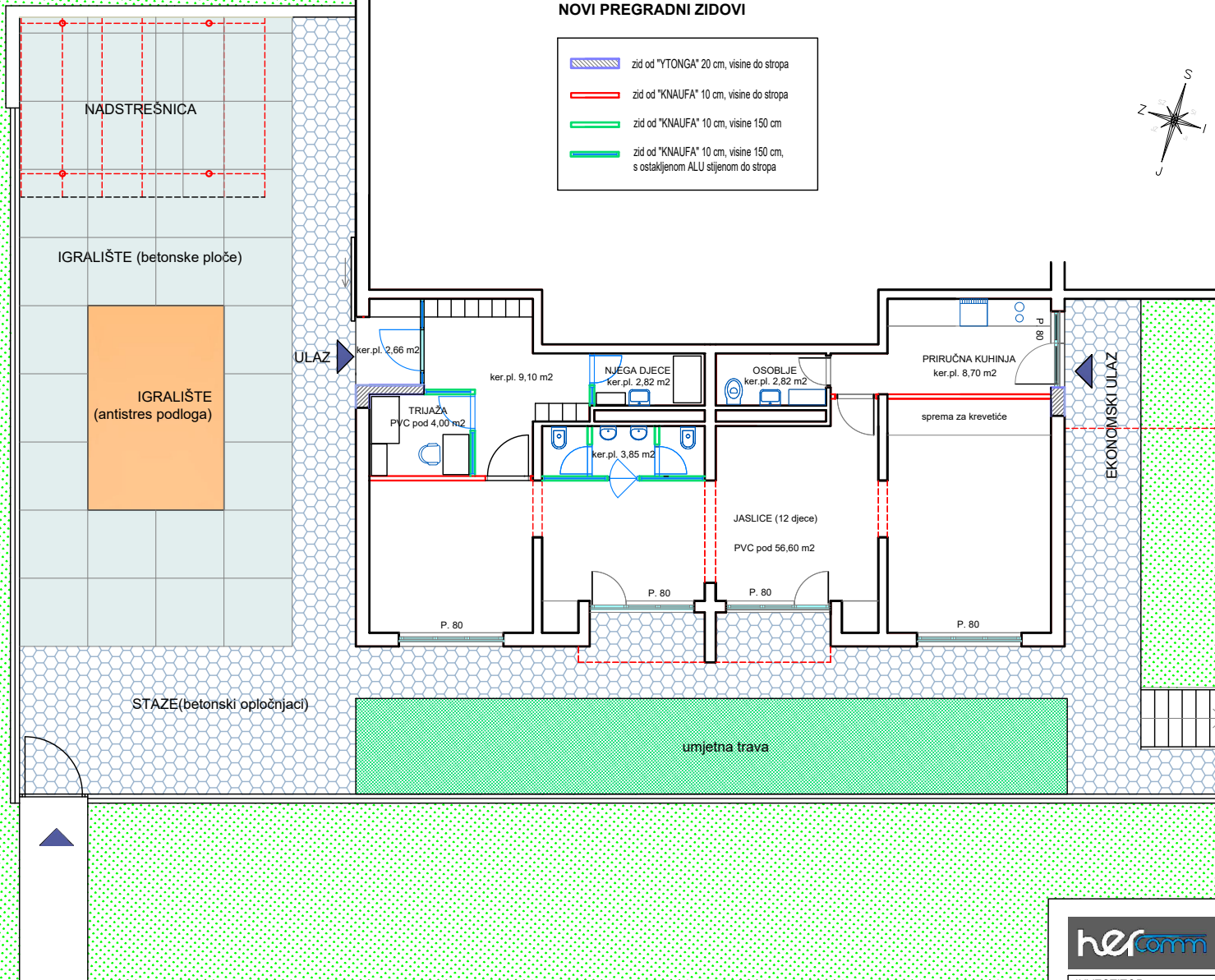

hercomm

d.o.o. SPLIT
PROJEKTIRANJE, INVESTIRANJE, INŽENJERING

INVESTITOR	GRAD SPLIT		
GRADEVINA	JASLICE - Stepinčeva 3. Split		
PROJEKT	IDEJNI ARHITEKTONSKI		
SADRŽAJ	TLOCRT PRIZEMLJA - novo stanje		
GLAVNI PROJEKTANT	Simeon Kovačić dipl. ing. arh.		
SURADNICI	Dragan Rakela ing. građ..		
BR. TEHN. DNEVNIKA	DATUM	MJERILO	LIST
2/17 -GP	06. / 2019. god.	1 : 100	2